

Made of PTFE.

Temperature range: -200 to 260 °C

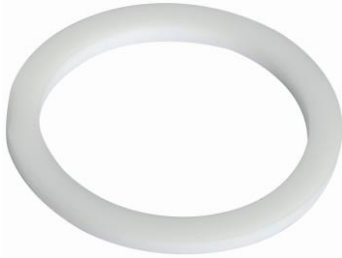

258.45

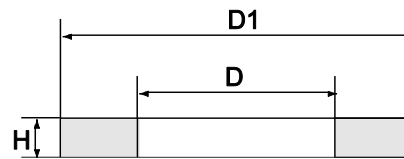

Sealing rings, PTFE					
Art. No.	Ident No.	For thread	D	D1	H
114109	258.40	M5	5.1 ±0.1	8.0 ±0.1	1.0 ±0.05
114110	258.41	G 1/8	10.0 ±0.15	13.0 ±0.15	1.5 ±0.2
114111	258.42	G 1/4	13.2 ±0.15	18.0 ±0.15	1.5 ±0.2
114112	258.43	G 3/8	16.8 ±0.15	22.0 ±0.15	1.5 ±0.2
114113	258.44	G 1/2	21.0 ±0.15	28.0 ±0.15	1.5 ±0.2
114114	258.45	G 3/4	26.5 ±0.15	33.0 ±0.15	2.0 ±0.2
114115	258.46	G 1	33.3 ±0.15	38.9 ±0.15	2.0 ±0.2